

mob

INSTALLATION INSTRUCTIONS

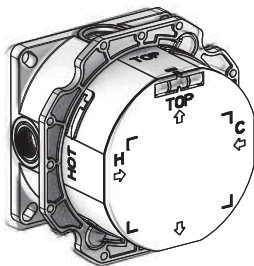

Before Installation

- We recommend that this product is installed by a qualified professional plumber / contractor.
- Please check this product immediately to ensure that it has not been damaged and is complete. Before installation, please make sure this product is the correct model and you have all the parts required for installation and using.
- Please flush the water system to ensure that no metal swarf, solder, and other impurities can enter the taps.
- Turn on water supply before commencing work, this should be done at the isolating valves of inlet feeds if fitted or main stopcock.
- Please read these instructions carefully and keep it for future reference.



Valve Box Basic Dimension

Unit: mm

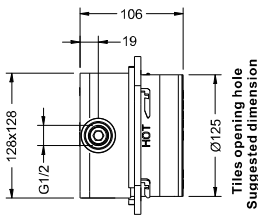
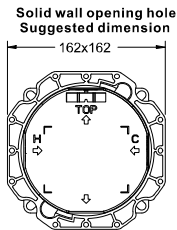

Opening Hole Suggested Dimension

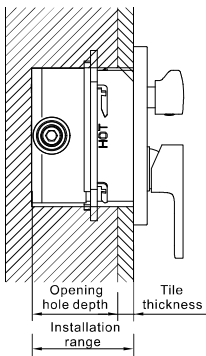

1. Opening hole depth is different according to different type of valve type. Please refer to the table on the next page.

Opening hole depth=installation range - tile thickness

2. If the opening hole depth is less than the Min cut depth, the trim plate may can't stick to the wall. Please contact your local distributor to buy the customized trim plate.

3. If the opening hole depth is more than the Max cut depth, then the handle may can't work properly. Please contact your local distributor to buy the auxiliary plate.

4. Please determine the opening hole depth before you cut the wall. If because of special circumstances can not be normally embedded, it is best to bury deep not shallow.

Embedded Depth Reference Table

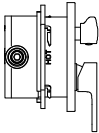
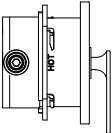
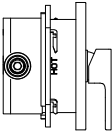
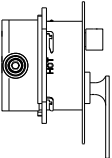
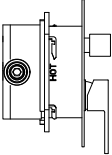
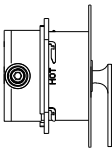
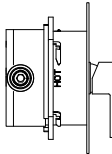
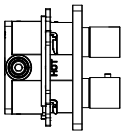
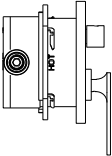
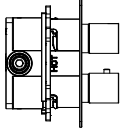
Valve type	Valve features	Installation depth	Valve type	Valve features	Installation depth
	Thick trim plate Normal handle Double function	81-97mm		Thick trim plate Small handle Single function	72-109mm
	Thick trim plate Normal handle Single function	72-97mm		Slim trim plate Small handle Double function	91-113mm
	Slim trim plate Normal handle Double function	91-107mm		Slim trim plate Small handle Single function	72-119mm
	Slim trim plate Normal handle Single function	76-107mm		Thick trim plate Thermostatic	73-103mm
	Thick trim plate Small handle Double function	81-103mm		Slim trim plate Thermostatic	83-113mm

Installation Procedure

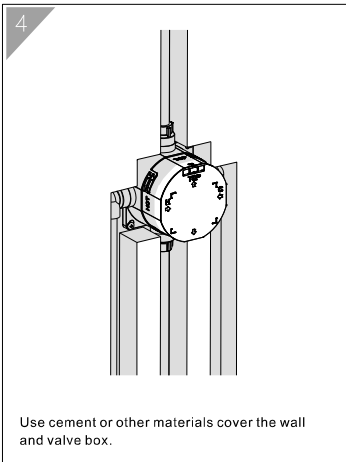
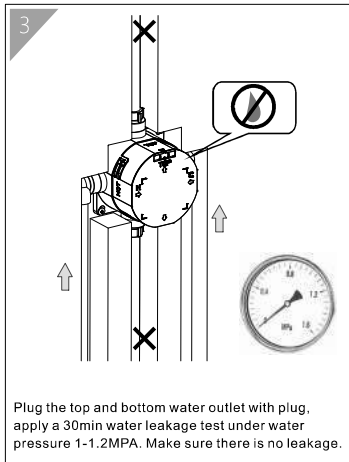
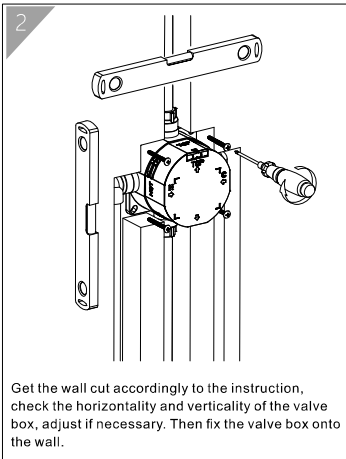
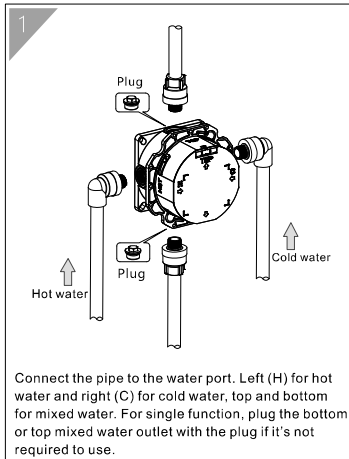

Installation Procedure

5

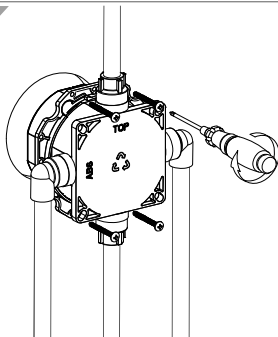

Get the hollow wall cut, and install the box and valve from the back of hollow wall, then fix the screws.

6

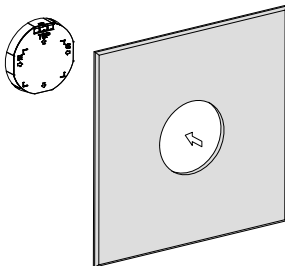

Put on the tiles or other materials, make surface are even and flat.

7

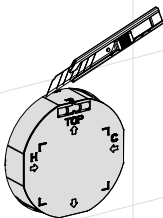

Cut the plaster shield and make sure the valve box is at the same lever of the finished wall.

8

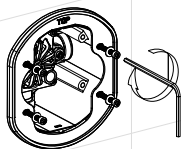

Install the fixing plate. (For the valve with 3mm trim plates no need to install this)

9



Open the ball valve and flush the pipe.

10



Close the ball valve, take off the anti-dust cover and sealing block.

11

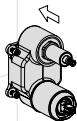

Double function control valve installation-A:

Fix the control valve body on the valve box (please confirm the o rings on the bottom of control valve is not missing).

12

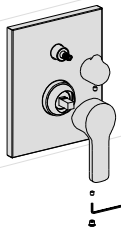

Double function control valve installation-B:

Install the trim plate, on-off handle and diverter handle accordingly.

13

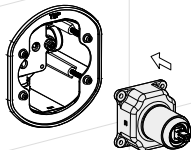

Single function control valve installation-A:

Fix the control valve body on the valve box (please confirm the o rings on the bottom of control valve is not missing).

14

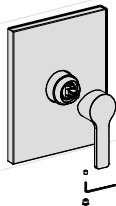

Single function control valve installation-B:

Install the trim plate and on-off handle.

15

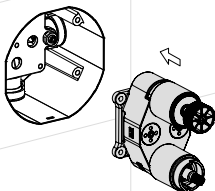

Thermostatic control valve installation-A:

Fix the control valve body on the valve box (please confirm the o rings on the bottom of control valve is not missing).

16

When the red marking line is facing up, install the handle upward as shown in the product diagram.

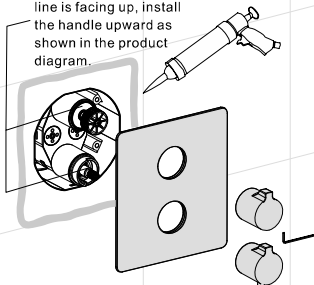

Thermostatic control valve installation-B:

Install the trim plate, thermostatic handle and on-off handle. (for slim trim plate, fix it on wall with glue)

Instructions

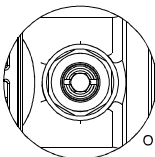
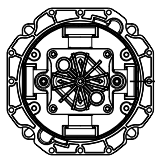

OPEN

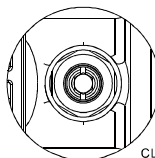

CLOSE

Open: stop valve is horizontal
Close: stop valve is vertical

Double function control valve

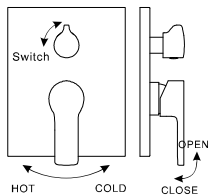

Double function thermostatic control valve

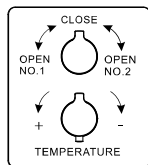

Press to unlock

Single function control valve

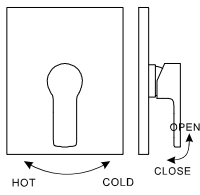

Single function thermostatic control valve

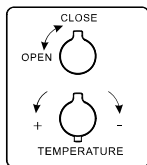

Press to unlock

If water pressure between the hot and cold water is very large , then can adjust the stop valve for a better performance.

Use cleaning materials which are explicitly intended for this type of application frequently to clean the products. Never use cleaning materials which contain hydrochloric, formic, phosphoric, or acetic acid, as they cause considerable damage.